

## Electric chain hoist

Applicable Type	Diameter (mm)D	Inside length (mm)P	Inside width (mm)A	Outside width (mm)B	Work load (Kg)	Guaranteed load (KN)	Break load (KN)
SSDHL0.3-01	6.1	19	7.5	20	1100	26.5	45
SSDHL0.5-01	6.3	19	7.9	22	1120	27	47
SSDHL01-01 SSDHL02-02 SSDHL03-03	7.1	21	8.9	25	1600	37	61.6
SSDHL1.5-01 SSDHL02-01 SSDHL03-02	10.0	30	12.5	35	3200	76	125
SSDHL2.5-01 SSDHL03-01 SSDHL05-02 SSDHL7.5-03 SSDHL10-04 SSDHL15-06 SSDHL20-08 SSDHL25-08	11.2	34	14	39	3800	92	154

Hook: It is hot forging with perfect strength that is hard to break. The operation safety of the lower hook is ensured by its 360 degrees rotation and safety tongue piece.

Type	Load (T)	T	B	A	B	C	D	E	G
SSDHL	0.3, 0.5	T	B	27	18	25	17	35	28
	1	T	B	34	24	30	24	42	32
	2	T	B	46	29	39	30	49	40
	3	T	B	56	35	49	34	59	48
	5	T	B	67	43	57	44	60	48
	7.5	T	B	82	55	80	48	85	80
	10	T	B	82	55	80	48	85	80
	15	T	B	110	78	120	80	120	96
20, 25	T	B	142	95	155	98	150	115	

T- upper hook / B- lower hook

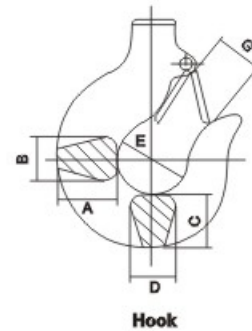
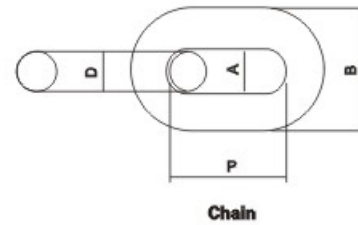

SSDHL 01 - 01 S

### Type

It's the general representation form of the hoist with Hook, Hoist with Electric Trolley and Hoist with Manual Trolley.

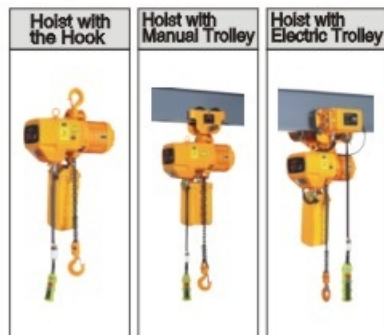

### Rated Capacity

Code	Rated Capacity
0.3	300Kg
0.5	500Kg
01	1t
1.5	1.5t
02	2t
2.5	2.5t
03	3t
05	5t
7.5	7.5t
10	10t
15	15t
20	20t
25	25t

Code	No. of load chain
01	1
02	2
03	3
04	4
06	6
08	8

S	Single speed
D	Dual speeds
L	type of super-low lifting
LD	Dual speeds of super-low lifting

» **Shell:** It is made of light aluminum alloy shell, light but hard. The cooling fin is specially designed to ensure quick heat dissipation with the rate up to 40% and continuous service. The integral enclosed structure is applicable to places like chemical plant and electroplate factory.

» **Side magnetic braking device:** The magnetic force generator is the latest design which is featured for generating magnetic force. It allows instant brake as soon as the electric power is cut off. Thus the braking safety while loading is guaranteed.

» **Limit switch:** The limit switch device is installed where the weight is lifted on and off to make the motor to stop automatically so as to prohibit the chains from exceeding for safety.

» **Chain:** The chain shall adopt the imported FEC80 ultra heat-treatable aluminum alloy chain. It can be safely used in poor environments such as rain, sea water and chemicals.

» **Hook:** It is hot forging with perfect strength that is hard to break. The operation safety of the lower hook is ensured by its 360 degrees rotation and safety tongue piece.

» **Support frame:** The loading support frame consists of two steel plates, which is extremely sturdy.

» **Transformer:** 24V/36V transformer device. This device is used to prohibit unexpected accidents caused by electric leakage and guarantees the safe use while raining.

» **Electromagnetic contactor:** Electromagnetic contactor can be used safely under high frequency.

» **Inverse phase sequence protecting device:** It is the special electrical installation which controls the circuit not to work in case of wiring error in the power supply.

» **Push button:** Waterproof push button is applied. It is light and durable.

» **Standard fittings** Chain bag (1) Control cable (3m) Push-button switch (1)

